

ASHOKA

INSTITUTIONAL | COMMERCIAL | INDUSTRIAL

## WHO WE ARE

The promoters at Ashoka Buildcon Limited have ventured into a new vertical, Ashoka Real Estate - Institutional, leveraging decades of expertise to cater to large-scale institutional, industrial, and commercial projects. The group is a well-established player across multiple sectors, including infrastructure development, railways, construction, power transmission and distribution, real estate, education, agriculture & bio-energy, and healthcare. In addition, Ashoka is emerging as a strong player in the fields of advertising, smart city solutions, and information technology.

With an expansive portfolio, Ashoka has extended its footprint internationally, delivering projects in countries such as the Maldives, Benin, Saudi Arabia, UAE, Bangladesh, Guyana, and Ghana. The group has earned recognition on national and international platforms for its commitment to speed, quality, consistency, environmental consciousness, and safety standards, positioning itself as one of the top infrastructure companies in the country. Whether on home soil or abroad, Ashoka continues to innovate, uphold sustainability, and deliver excellence across its diverse verticals.

# CHAIRMAN



## ASHOK KATARIYA

Ashoka Real Estate focuses on leveraging the expertise of Ashoka in creating Schools, Hospitals, Student Hostels, Co-Living Spaces, Co-Working Spaces, Warehouses, Data Centers, Fulfilment Centers, IT Parks, SEZ, Commercial Buildings etc. that blend elegance, comfort, natural surroundings and value for money. With a number of projects in full swing and more in the pipeline, the team of Ashoka Real Estate is all geared up to set new benchmarks in the real estate sector.

We have laid a strong foundation for the times to come built on quality, trust and commitment. We are committed to become an icon in the industry development, through innovation, professionalism, active leadership in product quality and sustained growth by delivering value to our customers.

.....*Way Forward*



# MANAGING PARTNERS



## ASHISH KATARIYA

Mr. Ashish A. Katariya, is MBA with Civil Engineering background and represents the next generation of the Ashoka's Management team. He possesses an experience of more than two decades, of which over 14 years of on-field experience is in infrastructure space and expertise in deployment of modern methods in highways construction. He has been involved in the successful completion of various Road Projects of ASHOKA.

He is also a Managing Director of Ashoka Concessions Limited ("ACL"), Subsidiary of the Company, and involved in effectively implementation of projects of awarded to ACL. He has been instrumental in the investment made by infrastructure finance giant SBI Macquarie in ACL to the tune of Rs.800 Cr.

Under his leadership Ashoka entered into City Gas Distribution ("CGD") Business. He has been instrumental in the investment made by infrastructure finance giant viz. Morgan Stanley in CGD Business of the Company to the tune of Rs.150 Crore.



# MANAGING PARTNERS



KEYUR MODI

"Lead fearlessly and be a motivation." It's what I am best at, and I'm helping others do the same.

A successful 1st generation entrepreneur needs more than a business and growing revenues. It needs stronger decisions, closed faster. Bringing life and success through his passion to all ventures he pursues, is what he does best. With more than two decades of experience in the construction field, he has been marching ahead fearlessly by exploring newer opportunities and challenges where he can make his mark.

The ability to take risks, prompt decision making, implementation of unorthodox strategies and the urge to deliver to the society is what inspires him to take up projects across the globe and stride relentlessly towards achieving his goals.



# OUR FOCUS



## INSTITUTIONAL

Schools  
Hospitals  
Colleges  
Hostels

## COMMERCIAL

IT Parks & SEZ  
Commercial Spaces  
Co-Living Spaces  
Retail

## INDUSTRIAL

Warehousing  
Industrial Spaces  
Fulfillment Centers  
Data Centre



# **INSTITUTIONAL**

## **SCHOOLS**



**INDO SCOT GLOBAL SCHOOL  
WAGHOLI, PUNE**



**RAHUL INTERNATIONAL SCHOOL  
HINJEWADI, PUNE**



**AMITY INTERNATIONAL SCHOOL  
CBD BELAPUR, NAVI MUMBAI**



**TREE HOUSE EDUCATION  
JHUNJHUNU, RAJASTHAN**



**ASHOKA UNIVERSAL SCHOOL  
WADALA, NASHIK**



**ASHOKA GLOBAL ACADEMY  
ARJUNNAGAR, NASHIK**



# INSTITUTIONAL

## SCHOOLS



**ASHOKA UNIVERSAL SCHOOL  
SINNAR, NASHIK**



**GLOBAL INDIAN SCHOOL  
KONDHWA, PUNE**



**BIRLA OPEN MINDS SCHOOL  
MANJRI, PUNE**



# INSTITUTIONAL

## COLLEGES



**ASHOKA BUSINESS SCHOOL  
RANENAGAR, NASHIK**



**ASHOKA COMPETITIVE STUDIES  
ARJUNNAGAR, NASHIK**

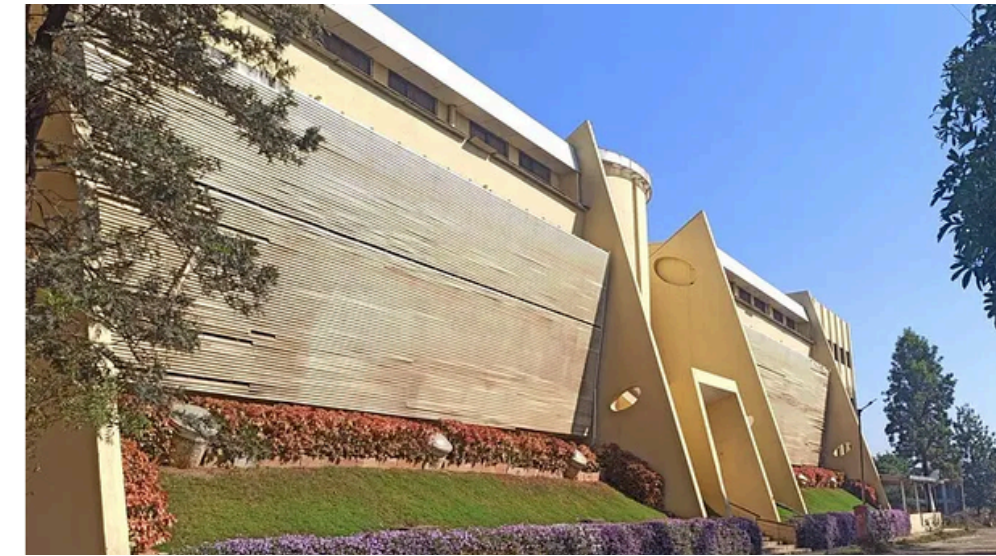

**INTL. EDUCATION RESEARCH  
CHANDSI, NASHIK**

## HOSPITALS



**MEDICOVER HOSPITAL  
WADALA, NASHIK**

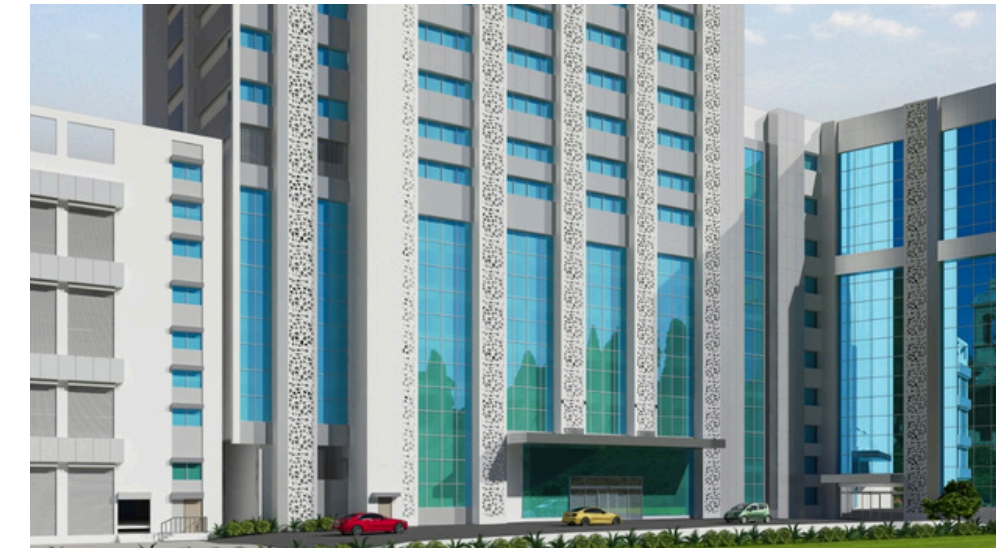

**SURYA MOTHER & CHILD CARE  
WADALA, NASHIK**

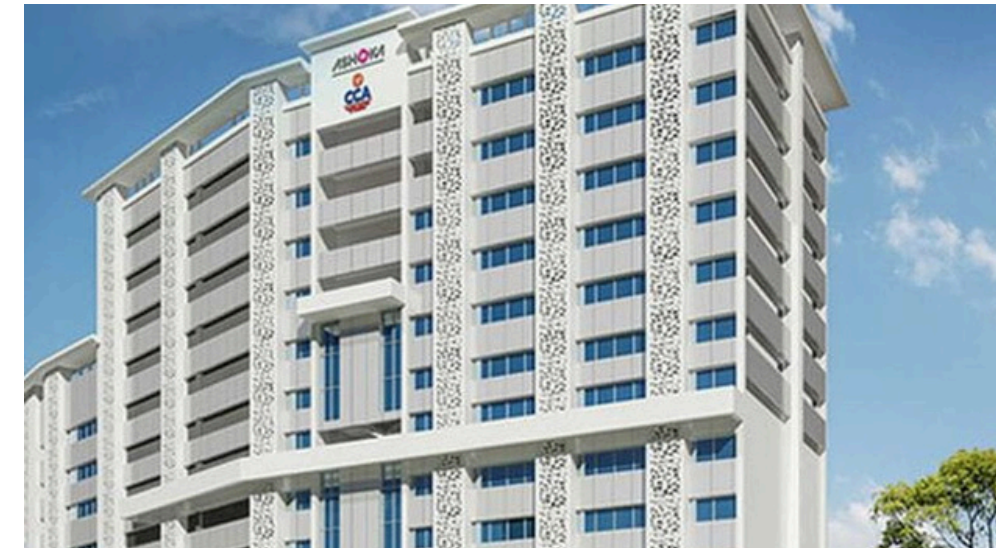

**AMERICAN ONCOLOGY CENTER  
WADALA, NASHIK**



# COMMERCIAL

## CO-LIVING



**ZOLO STAYS  
MANJRI, PUNE**

## IT PARKS & SEZ



**ASHOKA IT PARK  
HINJEWADI PHASE III, PUNE**

## RETAIL



**HIGH STREET  
MANJRI, PUNE**



**HIGH STREET  
HINJEWADI PHASE-1, PUNE**



# COMMERCIAL

## OFFICE SPACES

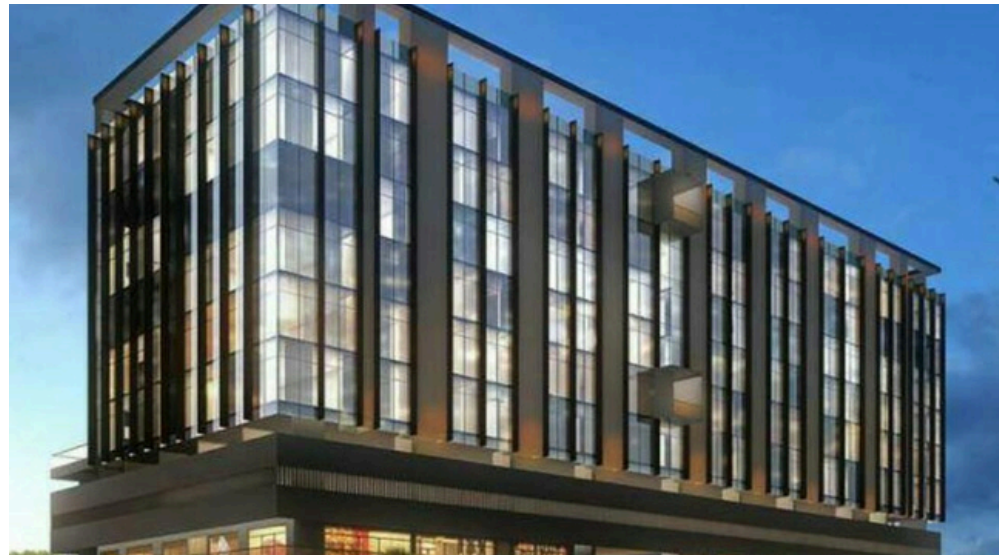

**BUSINESS PARK PHASE-1  
HINJEWADI, PUNE**



**BUSINESS ENCLAVE ONE  
PRATAPNAGAR, NASHIK**



**BUSINESS ENCLAVE TWO  
PRATAPNAGAR, NASHIK**



# INDUSTRIAL

## INDUSTRIAL PARK & WAREHOUSING



**ASHOKA GLOBAL PARK  
PHULGAON, PUNE**



**ASHOKA INDUSTRIAL PARK  
MARKAL, PUNE**



**SAMSONITE SOUTH ASIA  
GONDE, NASHIK**

## DATA CENTER



**HINJEWADI PHASE III  
PUNE**

# ALLIANCES





# ALLIANCES



# ALLIANCES





INSTITUTIONAL | COMMERCIAL | INDUSTRIAL

#### PUNE OFFICE

Lotus House East, Lane E  
Near Prim Rose School  
KoregaonPark, Pune 411001

Phone: +91 20 67070700

#### REGISTERED OFFICE

S. No 861, Ashoka House,  
Ashoka Marg, Ashoka Nagar,  
Nashik 422011

Phone: + 91 253 3011705

#### CORPORATE OFFICE

The Capital Building,  
A/807, 8th Floor, BKC  
Bandra ( E) Mumbai – 400051

Phone: + 91 022 67399700

Email: [info@ashoka.org.in](mailto:info@ashoka.org.in)

[www.ashoka.org.in](http://www.ashoka.org.in)